

**TECHNICAL MANUAL**

**OPERATOR'S, ORGANIZATIONAL, DIRECT SUPPORT  
AND GENERAL SUPPORT MAINTENANCE  
MANUAL INCLUDING REPAIR PARTS LIST  
FOR**

**BOOTH, SPRAYING  
MODEL 225A  
INLAND MFG. CO.  
(NSN 4940-00-078-4126)**

---

**HEADQUARTERS, DEPARTMENT OF THE ARMY  
OCTOBER, 1981**



TECHNICAL MANUAL }  
No. 9-4940-538-14&P }

HEADQUARTERS  
DEPARTMENT OF THE ARMY  
WASHINGTON, DC, 9 OCTOBER 1981

**Operator's, Organizational, Direct Support  
And General Support Maintenance Manual  
Including Repair Parts List  
For  
BOOTH, SPRAYING  
Model 225A  
NSN 4940-00-078-4126**

**REPORTING ERRORS AND RECOMMENDING IMPROVEMENTS**

You can help improve this manual. If you find any mistakes or if you know of a way to improve the procedures, please let us know. Mail your letter, DA Form 2028 (Recommended Changes to Publications and Blank Forms), or DA Form 2028-2, located in the back of this manual direct to: Commander, US Army Armament Materiel Readiness Command, ATTN: DRSAR-MAS, Rock Island, IL 61299. A reply will be furnished directly to you.

**NOTE**

This manual is published for the purpose of identifying an authorized commercial manual for the use of the personnel to whom this equipment is issued.

Manufactured by: Inland Manufacturing Co.  
1108 Jackson St.  
Omaha, NB 68102

Procured under Contract No. DAAA09-79-F-8110

This technical manual is an authentication of the manufacturers' commercial literature and does not conform with the format and content specified in AR 310-3, Military Publications. This technical manual does, however, contain available information that is essential to the operation and maintenance of the equipment.

**INSTRUCTIONS FOR REQUISITIONING PARTS  
NOT IDENTIFIED BY NSN**

When requisitioning parts not identified by National Stock Number, it is mandatory that the following information be furnished the supply officer.

- 1 - Manufacturer's Federal Supply Code Number - 92418
- 2 - Manufacturer's Part Number exactly as listed herein.
- 3 - Nomenclature exactly as listed herein, including dimensions, if necessary.
- 4 - Manufacturer's Model Number - 225A
- 5 - Manufacturer's Serial Number (End Item)
- 6 - Any other information such as Type, Frame Number, and Electrical Characteristics, if applicable.
- 7 - If DD Form 1348 is used, fill in all blocks except 4, 5, 6, and Remarks Field in accordance with AR 725-50.

**Complete Form as Follows:**

(a) In blocks 4, 5, 6, list manufacturer's Federal Supply Code Number - 92418 followed by a colon and manufacturer's Part Number for the repair part.

(b) Complete Remarks Field as follows:

Noun: (nomenclature of repair part)

For: NSN 4940-00-078-4126

Manufacturer: Inland Mfg. Co.  
1108 Jackson Street  
Omaha, NB 68102

Model:

Serial: (of end item)

Any other pertinent information such as Frame Number, Type, Dimensions, etc.

## FLUSHING AND PAINT SPRAY BOOTH

	Page
1. Specifications . . . . .	2
2. Installation . . . . .	3
3. Installations Checkout . . . . .	3
4. Operation . . . . .	3
5. Preventative Maintenance . . . . .	4
Exploded View of Booth Mode 1225A . . . . .	5
Parts List . . . . .	6



## FLUSHING AND PAINT SPRAY BOOTH

Your new spray booth will accommodate radiators and heater cores from automobiles, trucks, tractors and industrial equipment of any size that can be placed inside the cabinet. It is used for external pressure washing and internal pressure flushing after vat cleaning. It is also used for painting the radiator. The Flushing and Paint Spray Booth is equipped with exhaust fan and water curtain to reduce paint fumes and fire hazards.

This equipment is constructed of the highest quality material and is manufactured in accordance with

strict quality assurance standards. Developed from vast experience in this field, it is designed to serve you faithfully, economically and profitably for many years.

The information contained in this manual will help you take advantage of all the features built into your machine for increased production and profits in the radiator business. Please read the instructions carefully. If you have any questions regarding the installation or operation of this machine, do not hesitate to contact us immediately.

## 1. SPECIFICATIONS

	<i>MODEL 225A</i>
Overall Dimensions:	66" left to right 38" front to back 90" high
Door Opening	51" wide, 61" high
Electrical:	1/2 H.P. Motor 115/60/1 8.4 AMPS
Exhaust Fan & Flue:	Six Blade -15"
Drain Both Units:	bottom
Net Weight:	800 lbs.



## **2. INSTALLATION (See Exploded View Drawing)**

2.1. To facilitate installation, locate unit near air, water, drain and electrical outlets.

2.1.1. Place unit over floor drain or use 2" diameter pipe to conduct water to floor drain and level.

2.1.2. Connect water and air to hoses furnished. Desirable air pressure for washing and back-flushing is 150 psi. Connect water curtain supply to 1/2" pipe at upper right side. Copper tubing with adapters may be used.

2.1.3. Connect power cord to 115 volt. The power cord is provided with a third wire for ground in accordance with standard safety practices. Since machine operates under moist conditions this ground must be permanently connected. An additional woven copper ground strap attached to the cabinet and to a water pipe is recommended as an additional safeguard.

2.1.4. Install stack pipe through ceiling for proper air flow from exhaust. This pipe should avoid sharp turns. A straight run is recommended. A suitable rain shield is required.

Model 500 requires 12" pipe; Model 225A 15" pipe; Model 226 18" pipe.

## **3. INSTALLATION CHECKOUT**

3.1. Operate exhaust fan and check for exhaust air flow. (Fan switch is located on right side of cabinet near eye level.)

3.2. Make sure all hoses are connected and turn on water and air. Check for leaks.

## **4. OPERATION**

### **4.1. EXTERNAL WASHING**

4.1.1. Disconnect flush gun from side of booth and attach washing nozzle by means of snap-on coupling. Place radiator on rack. 4.1.2. With radiator upright, turn on flush gun water valve

and wash exterior of radiator with water pressure. Open flush gun air injector control valve intermittently to increase pressure. Wash radiator from back to front first; this avoids forcing bugs and gravel deeper into radiator core.

### **4.2. INTERNAL BACK FLUSHING**

4.2.1. Connect radiator outlet to booth hose. Clamp hose to radiator outlet using Universal Quick Acting Clamp, Catalog No. 3011.

4.2.2. Close booth door. Attach flush gun to fitting at right side of booth by means of snap on coupling.

4.2.3. Turn on flush gun water valve and back flush radiator by pressing flush gun air injector control lever. Keep lever depressed one or two seconds and repeat until water expelled from top of radiator is clear. Allow time for radiator fill with water between each injection of air pressure.

4.2.4. Turn radiator upside down and repeat water and air injection two or three times. This serves to remove heavy particles of rust and lime.

### **NOTE:**

The Models 225A and 226 are equipped with a hoist for handling large radiators.

### **4.3. PAINTING RADIATOR**

4.3.1. Radiator should be thoroughly dry before painting. Use Leak Exposer for fast drying.

4.3.2. Place radiator inside booth and turn on exhaust fan.

4.3.3. Turn on water curtain. This provides a light flow of water behind the radiator to eliminate paint build up on the baffle of the booth. **IMPORTANT:** Use care when adjusting water curtain valve. A heavy curtain of water will cause water to fall on radiator.

**NOTE:**

Baffle Plate at rear of booth must be kept clean. Excessive build up of paint on the baffle will cause the water to spray.

4.3.4. Paint radiator with spray gun provided. use special non-insulating black radiator paint, Catalog No. 2029.

**PREVENTATIVE MAINTENANCE**

5.1. FAN BLADES. Periodically remove baffle plate and clean fan blades of dried paint.

**CAUTION:**

Disconnect motor power plug before cleaning.

5.2. HOIST. Oil hoist mechanism and pulley with SAE 20 W oil.

5.3. SNAP-ON CONNECTIONS. Snap-on couplings require special washers. Replace as required.

**5.4. PAINT**

5.4.1. EXTERIOR PAINT. Exterior surfaces have been coated with Epoxy Red Oxide Metal Primer (Cat. #4016-P) and finished with a tough chemical resistant twocomponent catalyzed polyurethane safety orange (Cat. #4024). Clean and repaint surfaces as needed to preserve a good finish and an attractive appearance.

5.4.2. INTERIOR PAINT. The interior is coated with Epoxy Red Oxide Metal Primer, Cat. #4016-P and then coated with Spray Booth Coating. This protective coating prevents paint build up. When paint in interior is excessive, peel off coating and respray. Spray Booth Coating, Cat. #4030 is thinned with Thinner, Cat. #4030-A.

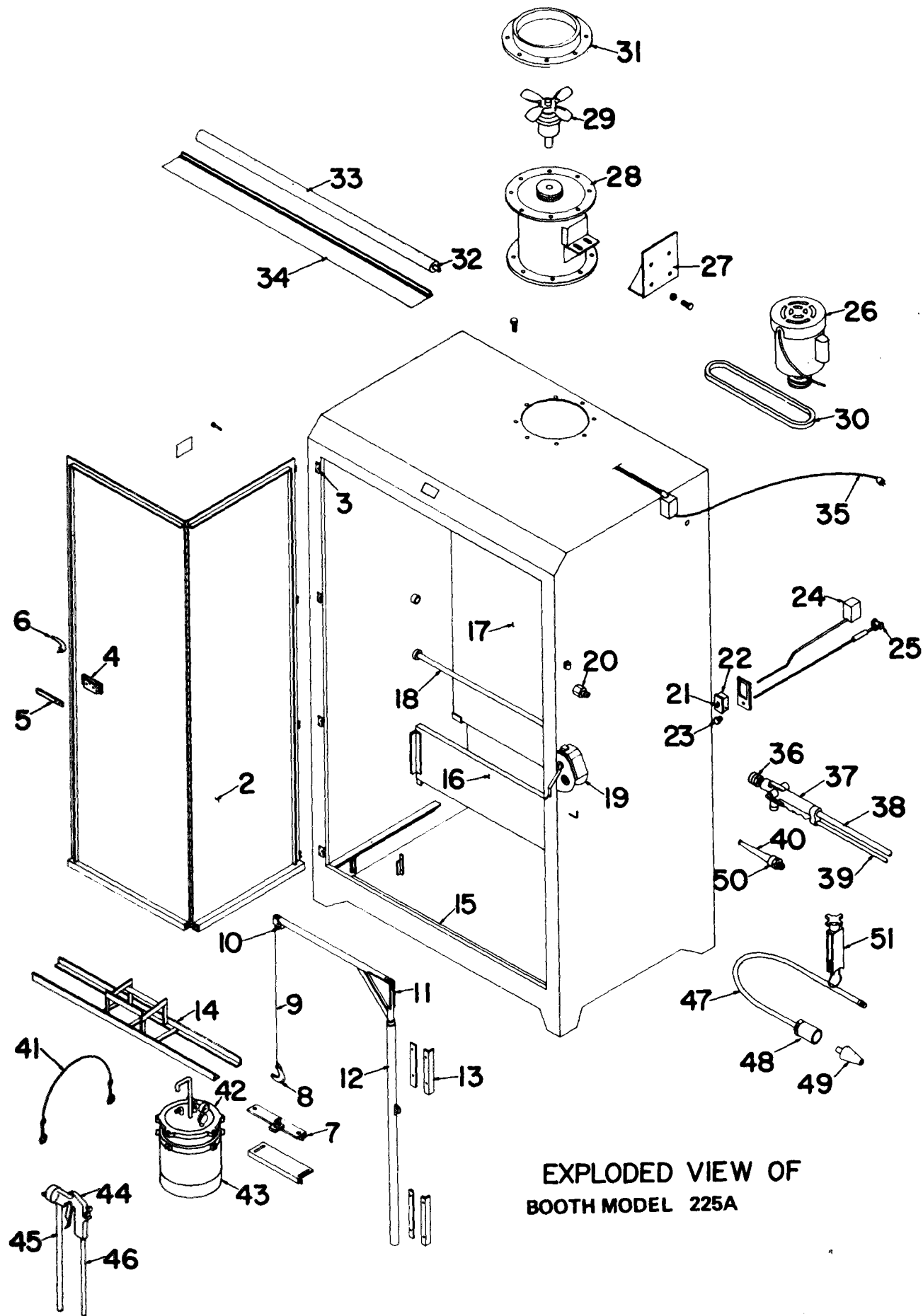

EXPLODED VIEW OF  
BOOTH MODEL 225A

# PARTS LIST

## MODEL 225A BOOTH

TJL 8-4-71

REF. NO.	PART NO.	NO. REQ.	DESCRIPTION
1	S-0082	1	CABINET BODY
2	S-0082	1	DOOR
3	H-0796	4	HINGE
4	H-0984	1	DOOR LATCH
5	S-0028	1	DOOR LOCKING LEVER
6	H-0782	1	DOOR LATCH LEVER
7	N-1237	1	HEADER CLAMP
8	N-1079	1	CABLE HOOK
9	N-1189	1	STAINLESS STEEL CABLE
10	W-0551	3	PULLEY
11	N-1243	1	HOIST PIVOT ASSEMBLY
12	P-0348	1	HOIST PIVOT SUPPORT
13	S-0005-31	2	HOIST BRACKETS
14	S-0005-29	1	RADIATOR SUPPORT RACK
15	S-0082	1	LOWER FRONT BAFFLE
16	S-0082	1	CENTER BAFFLE
17	S-0082	1	REAR BAFFLE
18	E-0109	1	RADIATOR REST BAR
19	M-0522	1	HOIST WINCH
20	P-0278	1	ZOO GUN NIPPLE
21	E-0152-212	1	SWITCH & 14 AMP HEATER
22	E-0135	1	SWITCH COVER
23	W-0566	1	WATER CURTAIN HAND WHEEL
24	E-0102	2	2X4 CONDUIT BOX
25	P-0404	1	1/2" WATER VALVE
26	E-0163	1	1/2" H.P. B.B. TEFC MOTOR
27	A-0713	1	MOTOR MOUNT
28	A-0713	1	BLOWER HOUSING
29	A-0713	1	BLOWER FAN BLADE
30	R-0584	1	DRIVE BELT 4L370
31	A-0713	1	BLOWER HOUSING COLLAR
32	P-0344	1	1/2" X 22 LG. WATER TUBE PIPE
33	P-0349	1	2" X 57" LG. WATER TUBE PIPE
34	S-0082	1	WATER CURTAIN DEFLECTOR
35	E-0125	1	POWER CORD





By Order of the Secretary of the Army:

Official:

ROBERT M. JOYCE  
*Brigadier General, United States Army*  
*The Adjutant General*

E. C. MEYER  
*General, United States Army*  
*Chief of Staff*





RECOMMENDED CHANGES TO EQUIPMENT TECHNICAL PUBLICATIONS



THEN... JOT DOWN THE DOPE ABOUT IT ON THIS FORM. CAREFULLY TEAR IT OUT. FOLD IT AND DROP IT IN THE MAIL!

SOMETHING WRONG WITH THIS PUBLICATION?

FROM: (PRINT YOUR UNIT'S COMPLETE ADDRESS)

Your mailing address

DATE SENT

Date you sent in form

PUBLICATION NUMBER

TM 9-4940-538-14&P

PUBLICATION DATE

9 Oct 81

PUBLICATION TITLE

Booth Spraying

BE EXACT... PIN-POINT WHERE IT IS

PAGE NO.	PARA-GRAPH	FIGURE NO.	TABLE NO.
10		2	

IN THIS SPACE TELL WHAT IS WRONG AND WHAT SHOULD BE DONE ABOUT IT:

Callout "15" is missing

SAMPLE

PRINTED NAME, GRADE OR TITLE, AND TELEPHONE NUMBER

JOHN DOE SP/4 XXX - XXXX

SIGN HERE:

*John Doe*

DA FORM 2028-2  
1 JUL 79

PREVIOUS EDITIONS ARE OBSOLETE.

P.S.--IF YOUR OUTFIT WANTS TO KNOW ABOUT YOUR RECOMMENDATION MAKE A CARBON COPY OF THIS AND GIVE IT TO YOUR HEADQUARTERS.

FILL IN YOUR  
UNIT'S ADDRESS

FOLD BACK

DEPARTMENT OF THE ARMY

POSTAGE AND FEES PAID  
DEPARTMENT OF THE ARMY  
DOD 314



OFFICIAL BUSINESS  
PENALTY FOR PRIVATE USE \$300

Commander  
US Army Armament Materiel Readiness Command  
ATTN: DRSAR-MAS  
Rock Island, IL 61299

TEAR ALONG PERFORATED LINE

RECOMMENDED CHANGES TO EQUIPMENT TECHNICAL PUBLICATIONS



THEN... JOT DOWN THE DOPE ABOUT IT ON THIS FORM. CAREFULLY TEAR IT OUT. FOLD IT AND DROP IT IN THE MAIL!

**SOMETHING WRONG WITH THIS PUBLICATION?**

FROM: (PRINT YOUR UNIT'S COMPLETE ADDRESS)

DATE SENT

PUBLICATION NUMBER TM 9-4940-538-14&P	PUBLICATION DATE 9 Oct 81	PUBLICATION TITLE Booth Spraying
--	------------------------------	-------------------------------------

BE EXACT... PIN-POINT WHERE IT IS				IN THIS SPACE TELL WHAT IS WRONG AND WHAT SHOULD BE DONE ABOUT IT:
PAGE NO.	PARA-GRAPH	FIGURE NO.	TABLE NO.	

TEAR ALONG PERFORATED LINE

PRINTED NAME, GRADE OR TITLE, AND TELEPHONE NUMBER

SIGN HERE:

FILL IN YOUR  
UNIT'S ADDRESS

FOLD BACK

DEPARTMENT OF THE ARMY

POSTAGE AND FEES PAID  
DEPARTMENT OF THE ARMY  
DOD 316



OFFICIAL BUSINESS  
PENALTY FOR PRIVATE USE \$300

Commander  
US Army Armament Materiel Readiness Command  
ATTN: DRSAR-MAS  
Rock Island, IL 61299

TEAR ALONG PERFORATED LINE

RECOMMENDED CHANGES TO EQUIPMENT TECHNICAL PUBLICATIONS



THEN... JOT DOWN THE DOPE ABOUT IT ON THIS FORM, CAREFULLY TEAR IT OUT, FOLD IT AND DROP IT IN THE MAIL!

**SOMETHING WRONG WITH THIS PUBLICATION?**

FROM: (PRINT YOUR UNIT'S COMPLETE ADDRESS)

DATE SENT

PUBLICATION NUMBER

TM 9-4940-538-14&P

PUBLICATION DATE

9 Oct 81

PUBLICATION TITLE

Booth Spraying

BE EXACT... PIN-POINT WHERE IT IS

PAGE NO.

PARA-GRAPH

FIGURE NO.

TABLE NO.

IN THIS SPACE TELL WHAT IS WRONG AND WHAT SHOULD BE DONE ABOUT IT:

PRINTED NAME, GRADE OR TITLE, AND TELEPHONE NUMBER

SIGN HERE:

FILL IN YOUR  
UNIT'S ADDRESS

FOLD BACK

DEPARTMENT OF THE ARMY

POSTAGE AND FEES PAID  
DEPARTMENT OF THE ARMY  
DOD 314



OFFICIAL BUSINESS  
PENALTY FOR PRIVATE USE \$300

Commander  
US Army Armament Materiel Readiness Command  
ATTN: DRSAR-MAS  
Rock Island, IL 61299

TEAR ALONG PERFORATED LINE

RECOMMENDED CHANGES TO EQUIPMENT TECHNICAL PUBLICATIONS



THEN... JOT DOWN THE DOPE ABOUT IT ON THIS FORM. CAREFULLY TEAR IT OUT. FOLD IT AND DROP IT IN THE MAIL!

**SOMETHING WRONG** WITH THIS PUBLICATION?

FROM: (PRINT YOUR UNIT'S COMPLETE ADDRESS)

DATE SENT

PUBLICATION NUMBER

TM 9-4940-538-14&P

PUBLICATION DATE

9 Oct 81

PUBLICATION TITLE

Booth Spraying

BE EXACT... PIN-POINT WHERE IT IS

PAGE NO.	PARA-GRAPH	FIGURE NO.	TABLE NO.
----------	------------	------------	-----------

IN THIS SPACE TELL WHAT IS WRONG AND WHAT SHOULD BE DONE ABOUT IT:

TEAR ALONG PERFORATED LINE

PRINTED NAME, GRADE OR TITLE, AND TELEPHONE NUMBER

SIGN HERE:

FILL IN YOUR  
UNIT'S ADDRESS

FOLD BACK

DEPARTMENT OF THE ARMY

POSTAGE AND FEES PAID  
DEPARTMENT OF THE ARMY  
DOD 314



OFFICIAL BUSINESS  
PENALTY FOR PRIVATE USE \$300

Commander  
US Army Armament Materiel Readiness Command  
ATTN: DRSAR-MAS  
Rock Island, IL 61299

TEAR ALONG PERFORATED LINE





**TM 9-4940-538-14&P — BOOTH, SPRAYING MODEL 225A — 1981**